

1

2

3

4

A

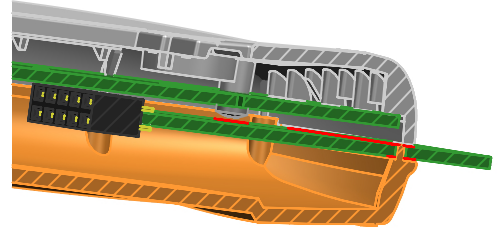
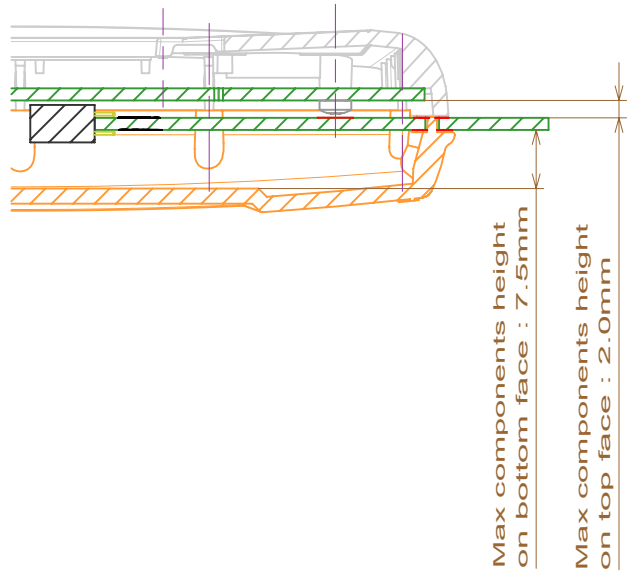

B

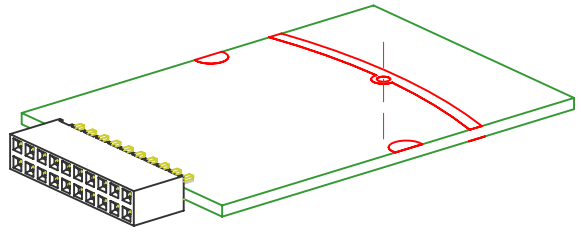

C

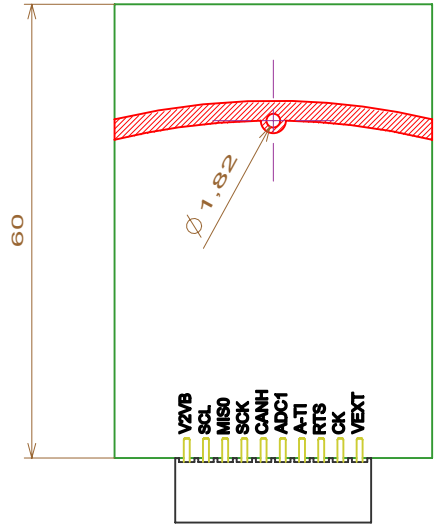
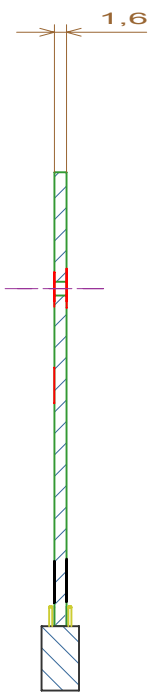
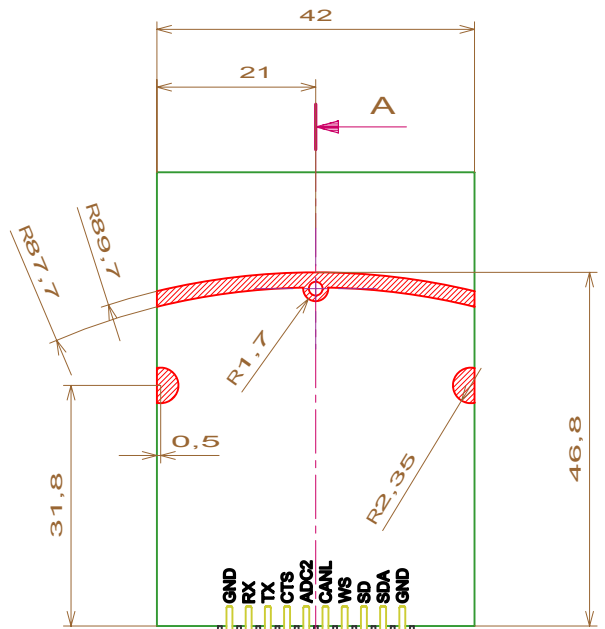

D

1

Top face

SECTION A-A

Bottom face

E

Note : Components are placed on the bottom face of the daughter board. Bottom face is the side of the board away from the motherboard/main board.

Note : red hatched zones : no component areas

1	[SSW 110 01 X D_SAMTEC HE14 FEM 20PTS (as ref)]	1
PC NO	PART NAME	QTY

Status

Tolerances generales

Etat de surface

Ce plan est la propriété de RAISONANCE et ne peut être reproduit ou communiqué sans son autorisation

www.raisonance.com

17 av J Kuntzmann

Traitement

RAISONANCE

1/1

Format A4

ECH 1/1

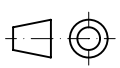

Folio

F

KeyOx PL

Raisonance FL

Date

Dessine / verifie par

Approuve par

Matiere

Poids

Des

K07145_1_113Z00 Primer BigSTM32 daughter board PCB